

11	
12	

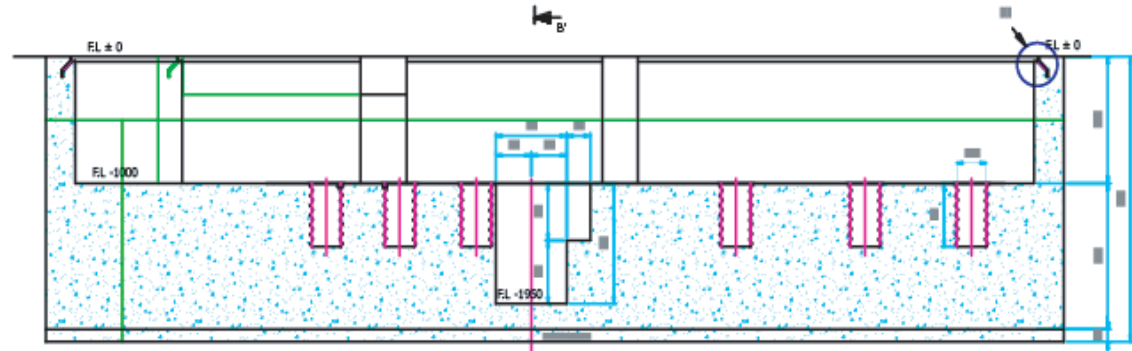
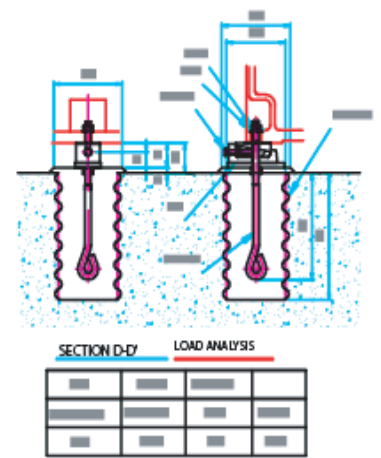
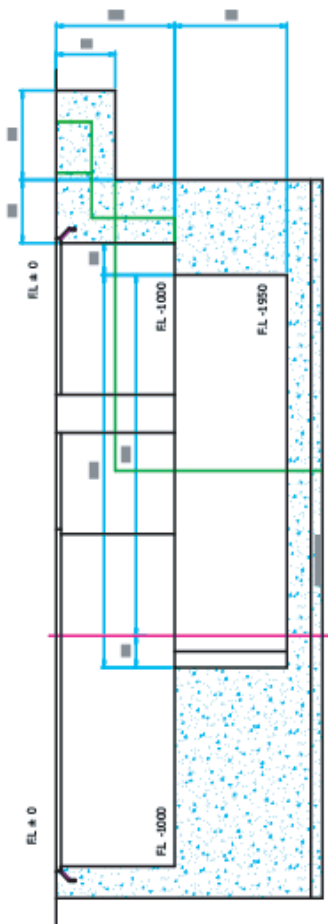
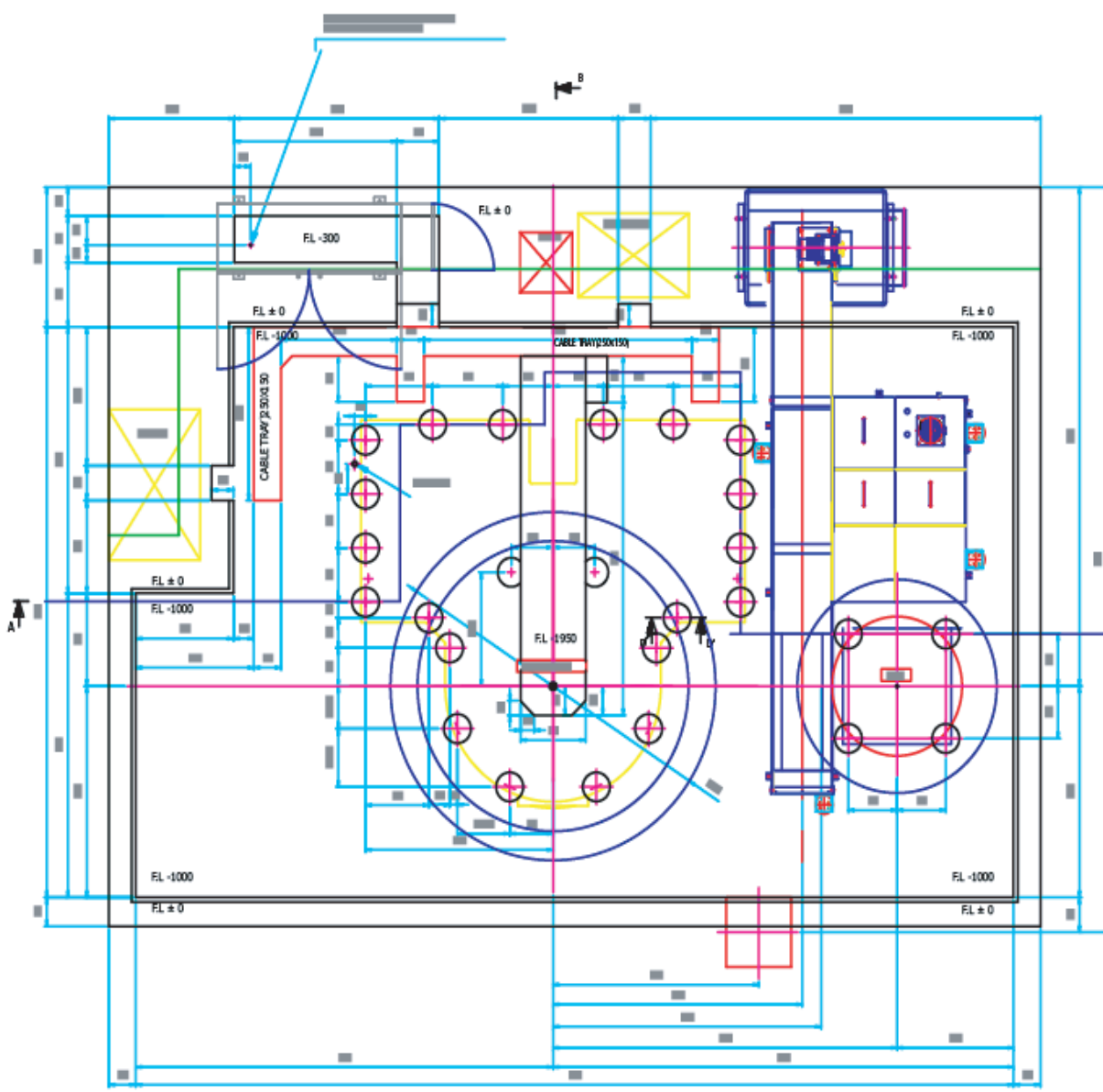

SEC. B-B'

- NOTE**
- Mortar for machine installation, use a nonshrink grout mortar. (Recommend mortar: MASTER FLOW 870-G)
 - Customer has to pour mortar into anchor holes.
 - Ground condition of foundation is to maintain over 14,223lb/in ground bearing for precision machine.
 - Be sure to pile into the ground if ground bearing is less than 14,223lb/in
 - Customer provide the PIT COVER around machine and CHECK PLATE ON HOLE after machine set up.
 - Customer provide the Utility line, Air line, Electric power and Water line by the machine.
 - Compressed air:
Volume: 17.6ft³/min, 1/2" pipe line pressure: over 71.115lb/in.
Electric power: 3PH 60Hz 120V/AA 065Q (projection length: 78.74inch).
Incoming power specification to the machine: 220V, 250A
 - Dimension of anchor hole: keep with In ± 0.197inch. Each hole is less than ± 0.394inch in total deviation.
 - Customer provide the flexible tube and cable tray etc. shown on foundation drawing.
 - For the machine installation 15ton lifting crane, lifting height 30ft.
 - This drawing is not available for foundation works. Customer provide complete drawing according to foundation condition with consulting. Example: structure, arrangement and reinforcement steel etc.